

## DRAFT ENVIRONMENTAL STATEMENT (VOLUME III)

### Crown Land Plans

#### HyNet Carbon Dioxide Pipeline DCO

Planning Act 2008

The Infrastructure Planning (Applications: Prescribed Forms and Procedure) Regulations 2009 –  
Regulations 5(2)(n)

Document Reference Number D.2.3

Applicant: Liverpool Bay CCS Limited

PINS Reference: EN070007

English Version

REVISION: B

DATE: March 2023

DOCUMENT OWNER: WSP UK Limited

PUBLIC

# QUALITY CONTROL

---

Document Reference		D.2.3		
Document Owner		WSP		
Revision	Date	Comments	Author	Approver
A	September 2022	Submitted with DCO application	PT	VB
B	March 2023	Update from S51 advice for Rev B	PT	VB



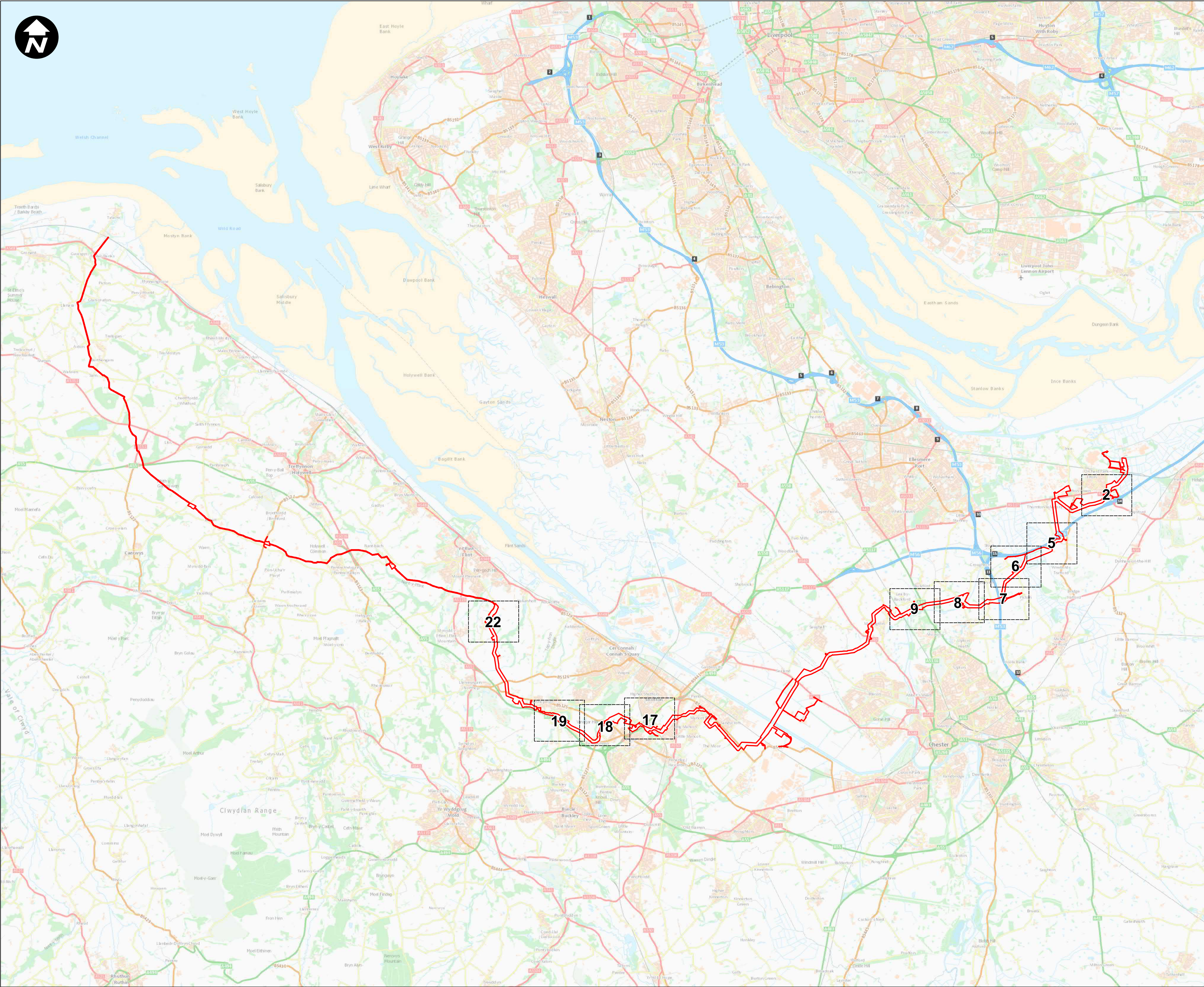

Service Layer Credits: Contains OS data © Crown Copyright and database right 2020

1:750,000

**Key:**

Order Limits

1. All dimensions are in metres unless stated otherwise.
2. These Land Plans should be read in conjunction with other plans and documents in the Development Consent Order application in particular the Book of Reference.
3. All easements, servitudes and private rights in land are proposed to be extinguished on land shown coloured pink on these land plans. All easements, servitudes and private rights in land are proposed to be extinguished, so far as their continued exercise would be inconsistent with the exercise of the rights or restrictions proposed to be acquired by the undertaker on land shown coloured blue on these land plans. All easements, servitudes and private rights are proposed to be suspended while the undertaker is in temporary possession of the land shown coloured green on these land plans.
4. The number labels relate to plot numbers. Please refer to the Book of Reference for more information about these plots, including the approximate area of each plot (in square metres). Plot numbers include a reference to the relevant sheet of the Land Plans. In this numbering convention, a plot number comprises the sheet number followed by the actual plot number, e.g. Plot 01-24, where '01' is the sheet number (sheet 1) and '24' is the plot number (24 on sheet 1).

B	NC	RB	VB	28/02/2023
A	PM	JH	VB	27/09/2022
REVISION	DRAWN	CHECKED	APPROVED	DATE

SCALE: 1:60,000

0

2,500

5,000

Metres

Mapping reproduced by permission of Ordnance Survey on behalf of HMSO

Contains OS data © Crown Copyright and database right 2022

# HyNet North West

PROJECT TITLE

## HyNet Carbon Dioxide Pipeline DCO

DRAWING TITLE

CROWN LAND PLANS REGULATION (5)(2)(n)  
APPLICATION DOCUMENT REFERENCE D.2.3  
KEY PLAN

DRAWING STATUS

ERRATA / S51 SUBMISSION

DRAWN	CHECKED	APPROVED	AUTHORISED
NC	RB	VB	AV
SCALE @ A1 SIZE	DATE	REVISION	
1:60,000	21/02/2023	B	

DRAWING NUMBER

EN070007-D.2.3-CLP-Key Plan



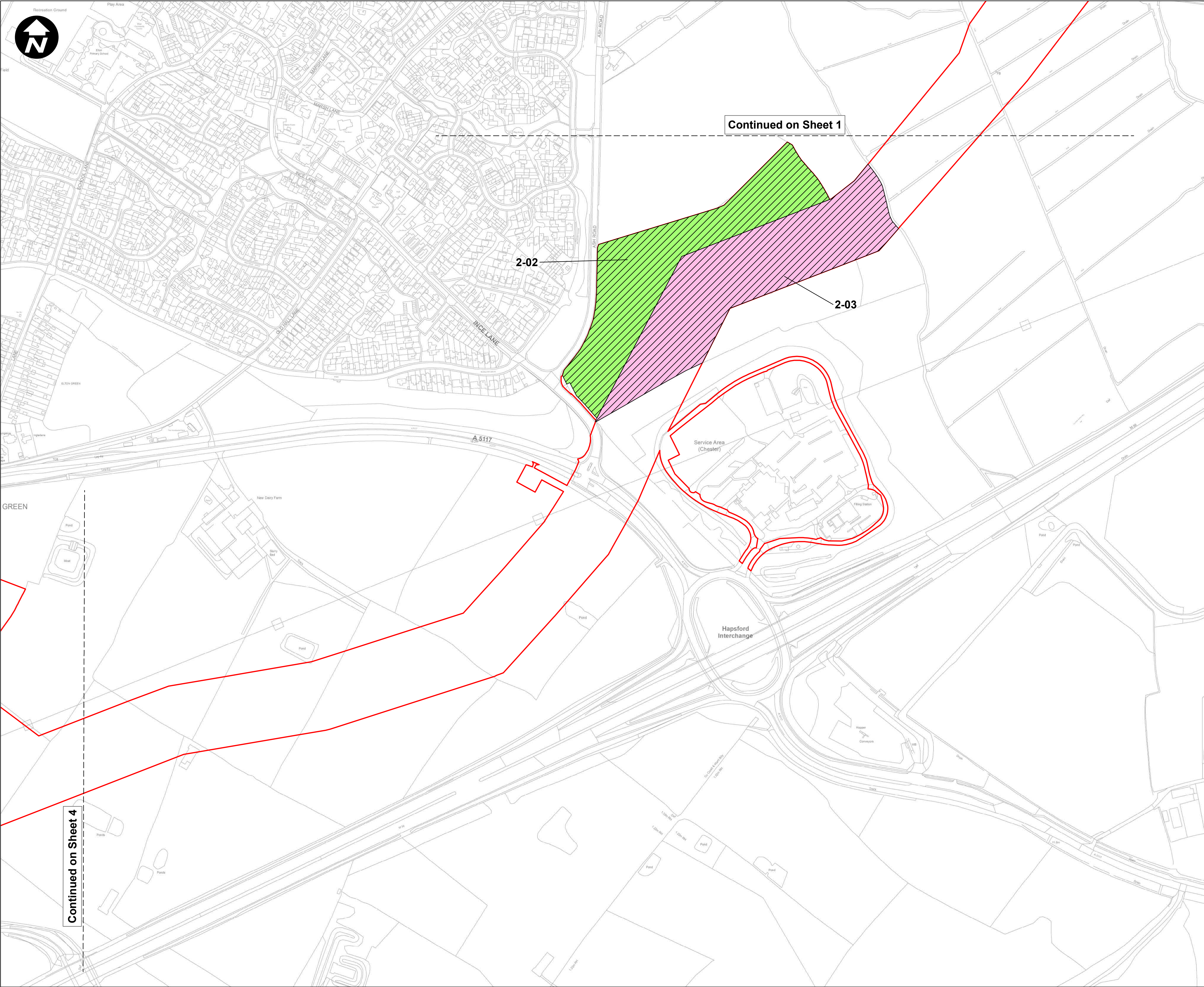

**Key:**

- Order Limits
- Permanent acquisition of subsurface
- Temporary possession of land
- Crown Land

1. All dimensions are in metres unless stated otherwise.
2. These Land Plans should be read in conjunction with other plans and documents in the Development Consent Order application in particular the Book of Reference.
3. All easements, servitudes and private rights in land are proposed to be extinguished on land shown coloured pink on these land plans. All easements, servitudes and private rights in land are proposed to be extinguished, so far as their continued exercise would be inconsistent with the exercise of the rights or restrictions proposed to be acquired by the undertaker on land shown coloured blue on these land plans. All easements, servitudes and private rights are proposed to be suspended while the undertaker is in temporary possession of the land shown coloured green on these land plans.
4. The number labels relate to plot numbers. Please refer to the Book of Reference for more information about these plots, including the approximate area of each plot (in square metres). Plot numbers include a reference to the relevant sheet of the Land Plans. In this numbering convention, a plot number comprises the sheet number followed by the actual plot number, e.g. Plot 01-24, where '01' is the sheet number (sheet 1) and '24' is the plot number (24 on sheet 1).

B	NC	RB	VB	28/02/2023
A	PM	JH	VB	27/09/2022
REVISION	DRAWN	CHECKED	APPROVED	DATE

**SCALE: 1:2,500**

0 50 100 200 Metres

Mapping reproduced by permission of Ordnance Survey on behalf of HMSO

Contains OS data © Crown Copyright and database right 2022

PROJECT TITLE

**HyNet Carbon Dioxide Pipeline DCO**

DRAWING TITLE

CROWN LAND PLANS REGULATION (5)(2)(n)  
APPLICATION DOCUMENT REFERENCE D.2.3  
SHEET 2 of 37

DRAWING STATUS

ERRATA / S51 SUBMISSION

DRAWN	CHECKED	APPROVED	AUTHORISED
NC	RB	VB	AV

SCALE @ A1 SIZE	DATE	REVISION
1:2,500	13/01/2023	B

DRAWING NUMBER

EN070007-D.2.3-CLP-Sheet 2



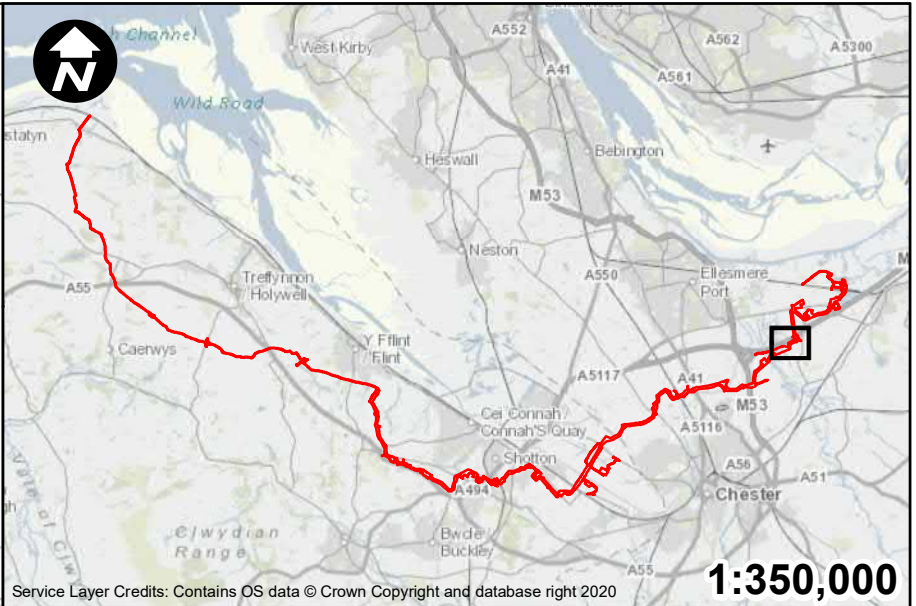
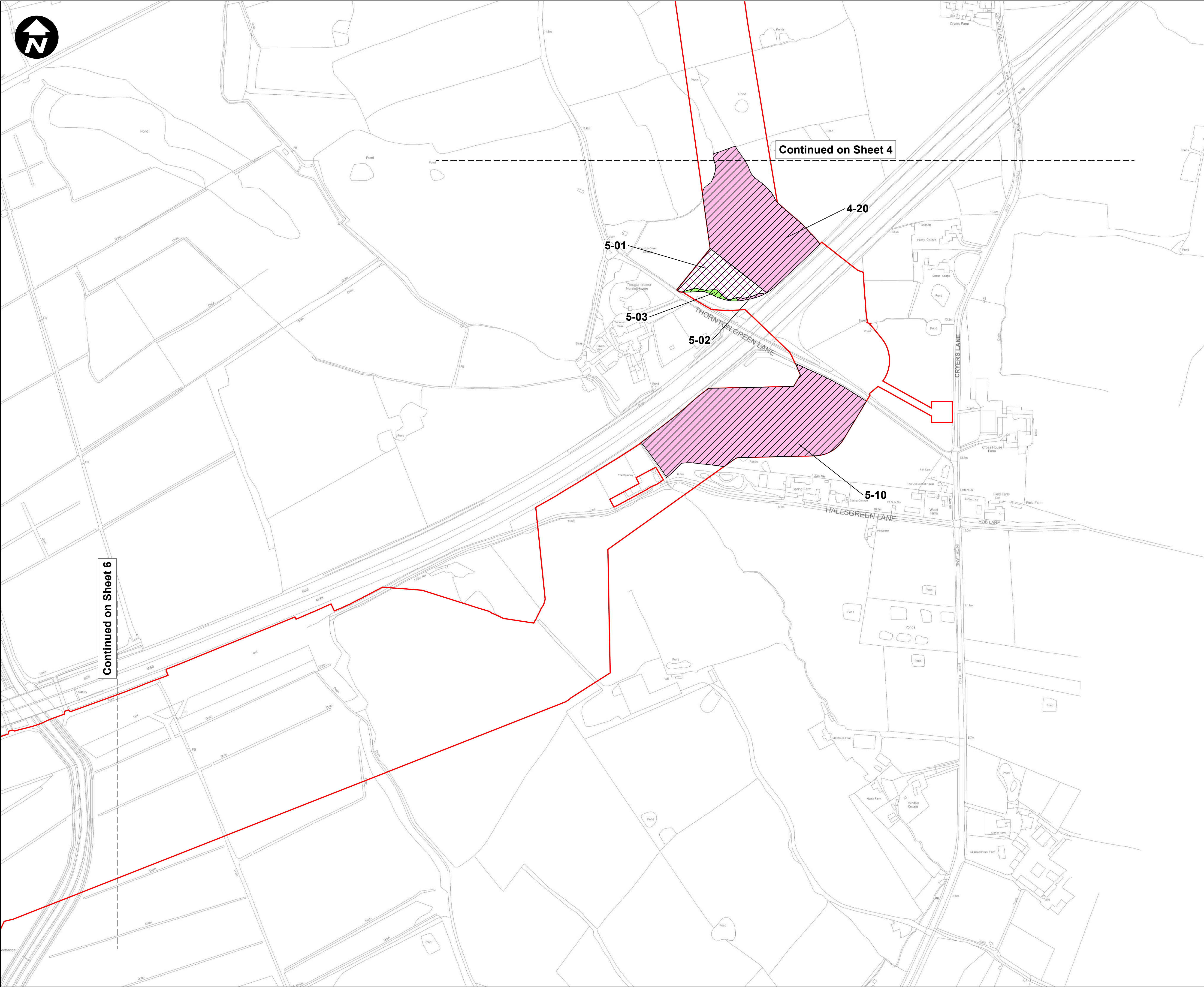

**Key:**

- Order Limits
- Permanent acquisition of land
- Permanent acquisition of subsurface
- Temporary possession of land
- Crown Land

1. All dimensions are in metres unless stated otherwise.
2. These Land Plans should be read in conjunction with other plans and documents in the Development Consent Order application in particular the Book of Reference.
3. All easements, servitudes and private rights in land are proposed to be extinguished on land shown coloured pink on these land plans. All easements, servitudes and private rights in land are proposed to be extinguished, so far as their continued exercise would be inconsistent with the exercise of the rights or restrictions proposed to be acquired by the undertaker on land shown coloured blue on these land plans. All easements, servitudes and private rights are proposed to be suspended while the undertaker is in temporary possession of the land shown coloured green on these land plans.
4. The number labels relate to plot numbers. Please refer to the Book of Reference for more information about these plots, including the approximate area of each plot (in square metres). Plot numbers include a reference to the relevant sheet of the Land Plans. In this numbering convention, a plot number comprises the sheet number followed by the actual plot number, e.g. Plot 01-24, where '01' is the sheet number (sheet 1) and '24' is the plot number (24 on sheet 1).

B	NC	RB	VB	28/02/2023
A	PM	JH	VB	27/09/2022
REVISION	DRAWN	CHECKED	APPROVED	DATE

**SCALE: 1:2,500**

0 50 100 200 Metres

Mapping reproduced by permission of Ordnance Survey on behalf of HMSO

Contains OS data © Crown Copyright and database right 2022

PROJECT TITLE

**HyNet Carbon Dioxide Pipeline DCO**

DRAWING TITLE

CROWN LAND PLANS REGULATION (5)(2)(n)  
APPLICATION DOCUMENT REFERENCE D.2.3  
SHEET 5 of 37

DRAWING STATUS

ERRATA / S51 SUBMISSION

DRAWN	CHECKED	APPROVED	AUTHORISED
NC	RB	VB	AV

SCALE @ A1 SIZE	DATE	REVISION
1:2,500	13/01/2023	B

DRAWING NUMBER

EN070007-D.2.3-CLP-Sheet 5



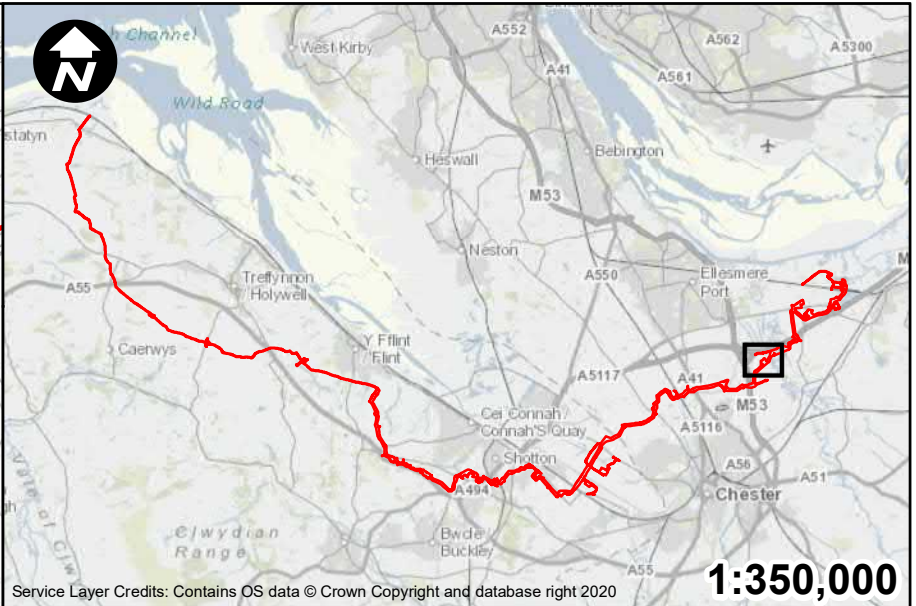
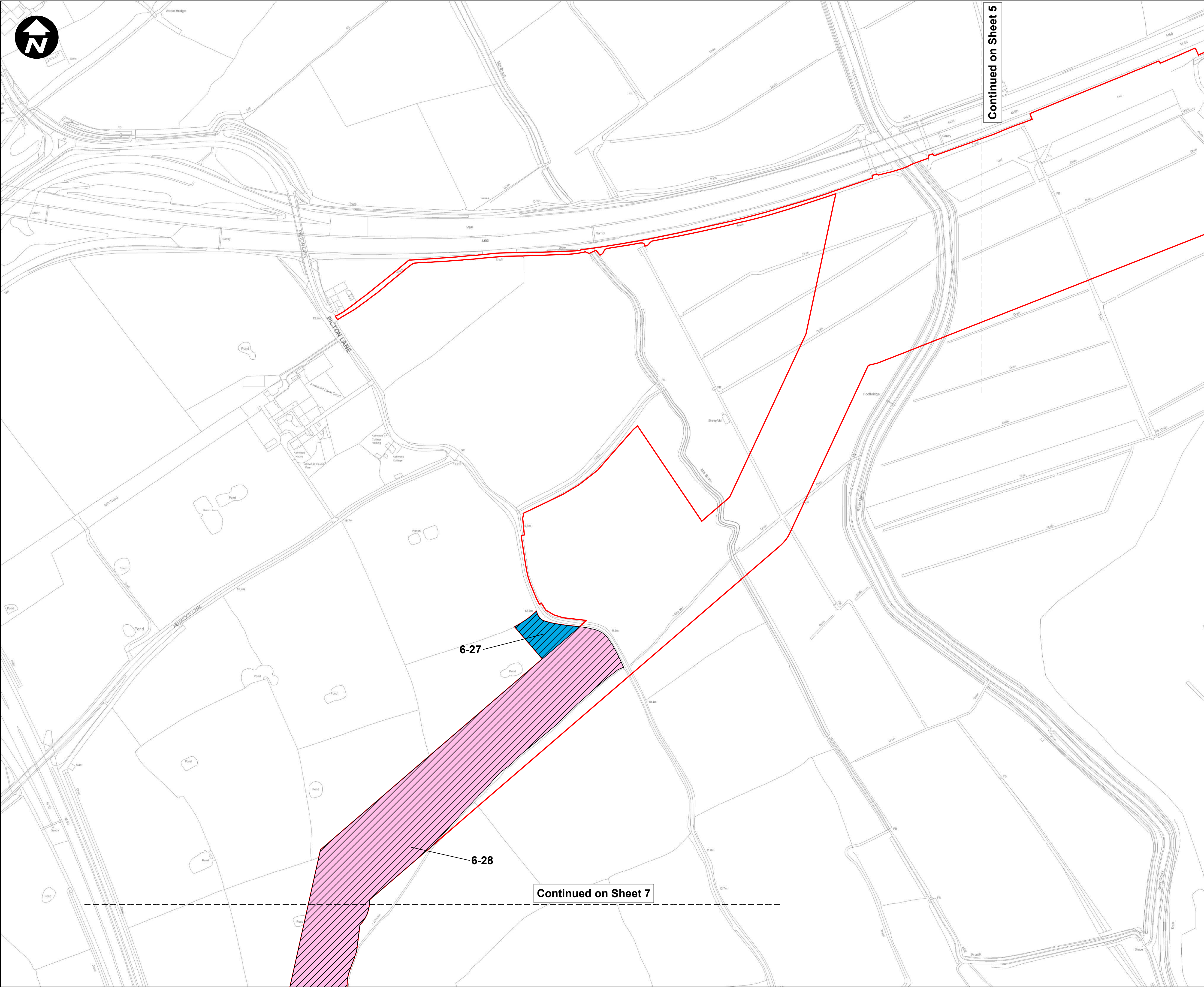

- Key:**
- Order Limits
  - Permanent acquisition of subsurface
  - Permanent acquisition of rights
  - Crown Land

1. All dimensions are in metres unless stated otherwise.
2. These Land Plans should be read in conjunction with other plans and documents in the Development Consent Order application in particular the Book of Reference.
3. All easements, servitudes and private rights in land are proposed to be extinguished on land shown coloured pink on these land plans. All easements, servitudes and private rights in land are proposed to be extinguished, so far as their continued exercise would be inconsistent with the exercise of the rights or restrictions proposed to be acquired by the undertaker on land shown coloured blue on these land plans. All easements, servitudes and private rights are proposed to be suspended while the undertaker is in temporary possession of the land shown coloured green on these land plans.
4. The number labels relate to plot numbers. Please refer to the Book of Reference for more information about these plots, including the approximate area of each plot (in square metres). Plot numbers include a reference to the relevant sheet of the Land Plans. In this numbering convention, a plot number comprises the sheet number followed by the actual plot number, e.g. Plot 01-24, where '01' is the sheet number (sheet 1) and '24' is the plot number (24 on sheet 1).

B	NC	RB	VB	28/02/2023
A	PM	JH	VB	27/09/2022
REVISION	DRAWN	CHECKED	APPROVED	DATE



Mapping reproduced by permission of Ordnance Survey on behalf of HMSO

Contains OS data © Crown Copyright and database right 2022

PROJECT TITLE

**HyNet Carbon Dioxide Pipeline DCO**

DRAWING TITLE

CROWN LAND PLANS REGULATION (5)(2)(n)  
APPLICATION DOCUMENT REFERENCE D.2.3  
SHEET 6 of 37

DRAWING STATUS

ERRATA / S51 SUBMISSION

DRAWN	CHECKED	APPROVED	AUTHORISED
NC	RB	VB	AV

SCALE @ A1 SIZE	DATE	REVISION
1:2,500	13/01/2023	B

DRAWING NUMBER

EN070007-D.2.3-CLP-Sheet 6



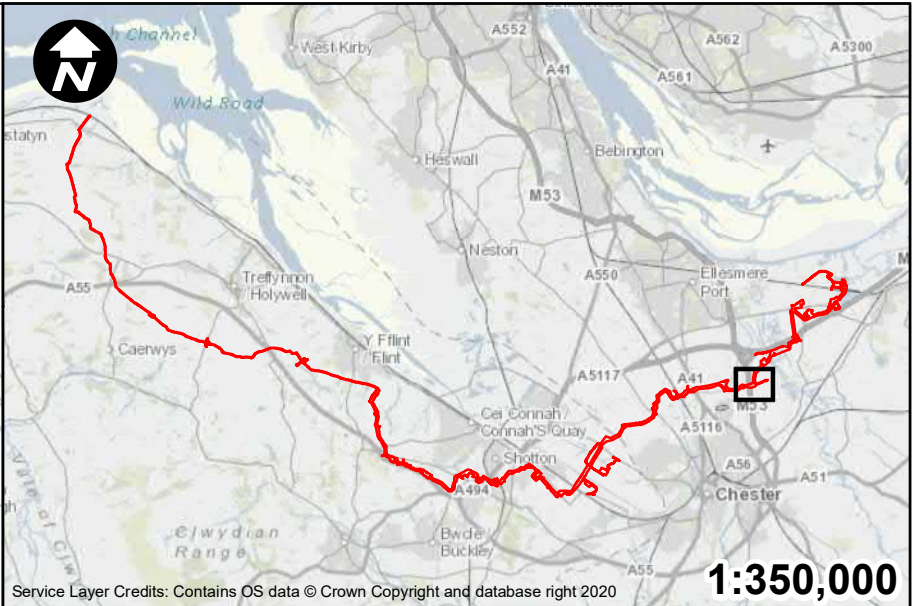
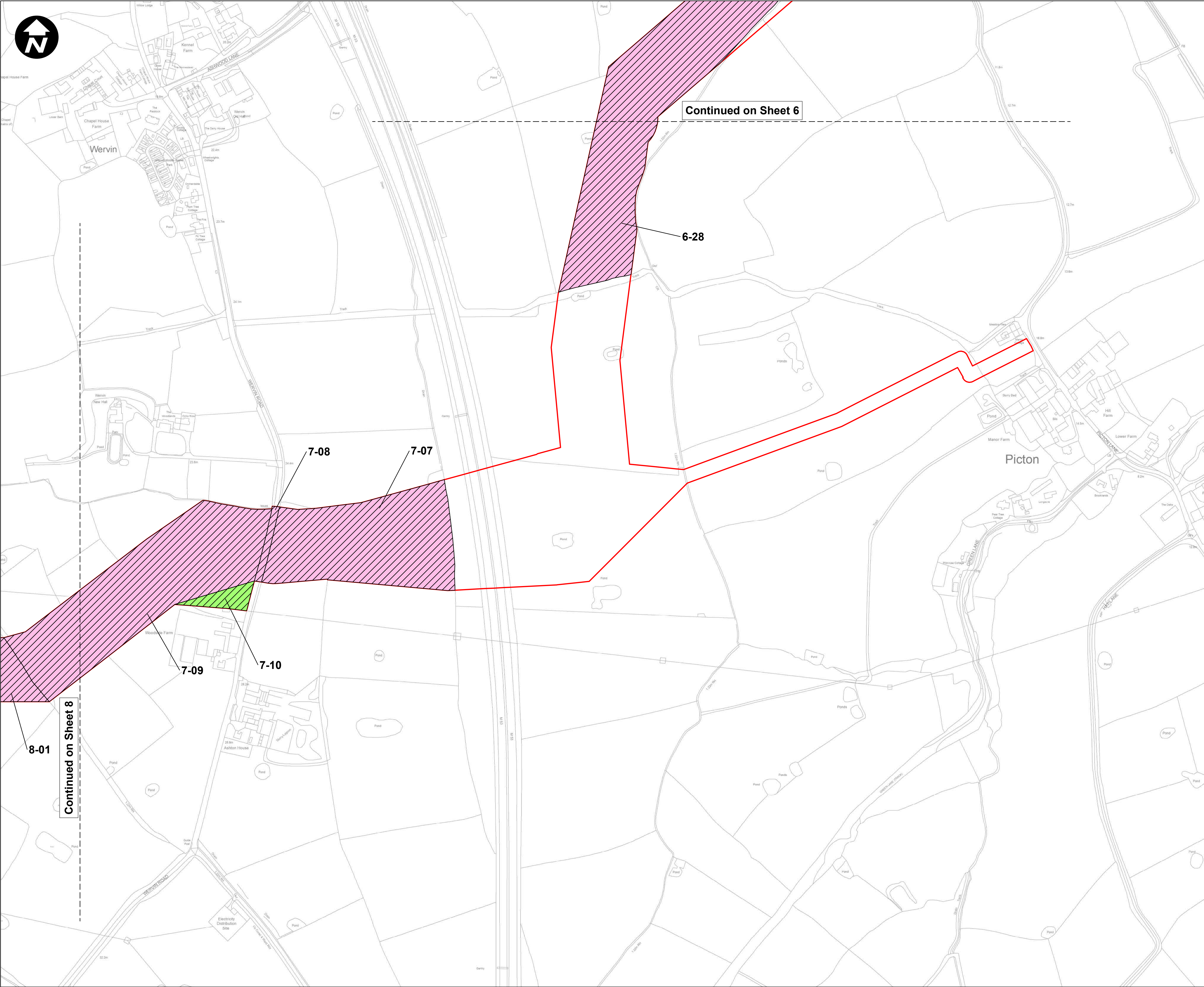

**Key:**

- Order Limits
- Permanent acquisition of subsurface
- Temporary possession of land
- Crown Land

1. All dimensions are in metres unless stated otherwise.
2. These Land Plans should be read in conjunction with other plans and documents in the Development Consent Order application in particular the Book of Reference.
3. All easements, servitudes and private rights in land are proposed to be extinguished on land shown coloured pink on these land plans. All easements, servitudes and private rights in land are proposed to be extinguished, so far as their continued exercise would be inconsistent with the exercise of the rights or restrictions proposed to be acquired by the undertaker on land shown coloured blue on these land plans. All easements, servitudes and private rights are proposed to be suspended while the undertaker is in temporary possession of the land shown coloured green on these land plans.
4. The number labels relate to plot numbers. Please refer to the Book of Reference for more information about these plots, including the approximate area of each plot (in square metres). Plot numbers include a reference to the relevant sheet of the Land Plans. In this numbering convention, a plot number comprises the sheet number followed by the actual plot number, e.g. Plot 01-24, where '01' is the sheet number (sheet 1) and '24' is the plot number (24 on sheet 1).

B	NC	RB	VB	28/02/2023
A	PM	JH	VB	27/09/2022
REVISION	DRAWN	CHECKED	APPROVED	DATE

**SCALE: 1:2,500**

0 50 100 200 Metres

Mapping reproduced by permission of Ordnance Survey on behalf of HMSO

Contains OS data © Crown Copyright and database right 2022

**HyNet North West**

PROJECT TITLE

**HyNet Carbon Dioxide Pipeline DCO**

DRAWING TITLE

CROWN LAND PLANS REGULATION (5)(2)(n)  
APPLICATION DOCUMENT REFERENCE D.2.3  
SHEET 7 of 37

DRAWING STATUS

ERRATA / S51 SUBMISSION

DRAWN	CHECKED	APPROVED	AUTHORISED
NC	RB	VB	AV

SCALE @ A1 SIZE	DATE	REVISION
1:2,500	13/01/2023	B

DRAWING NUMBER

EN070007-D.2.3-CLP-Sheet 7



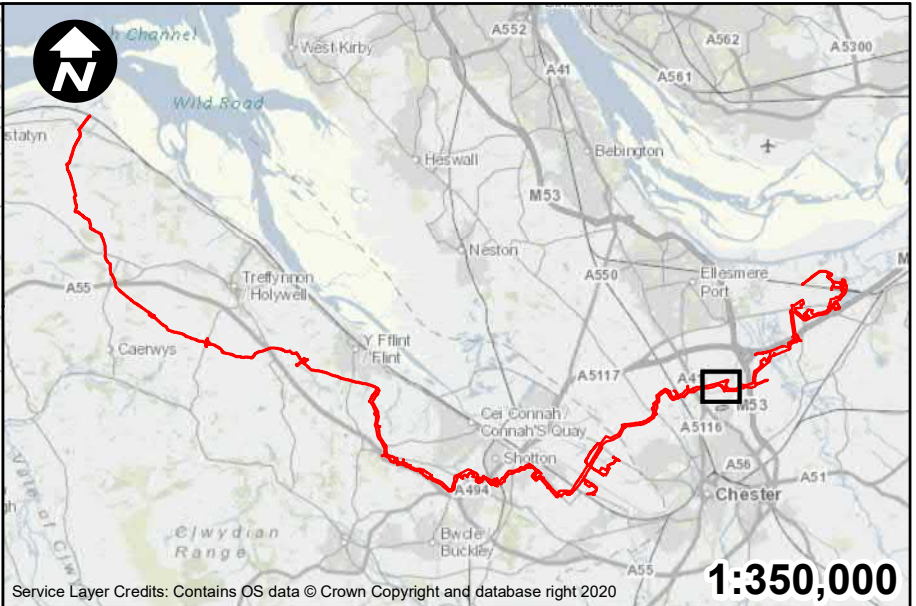
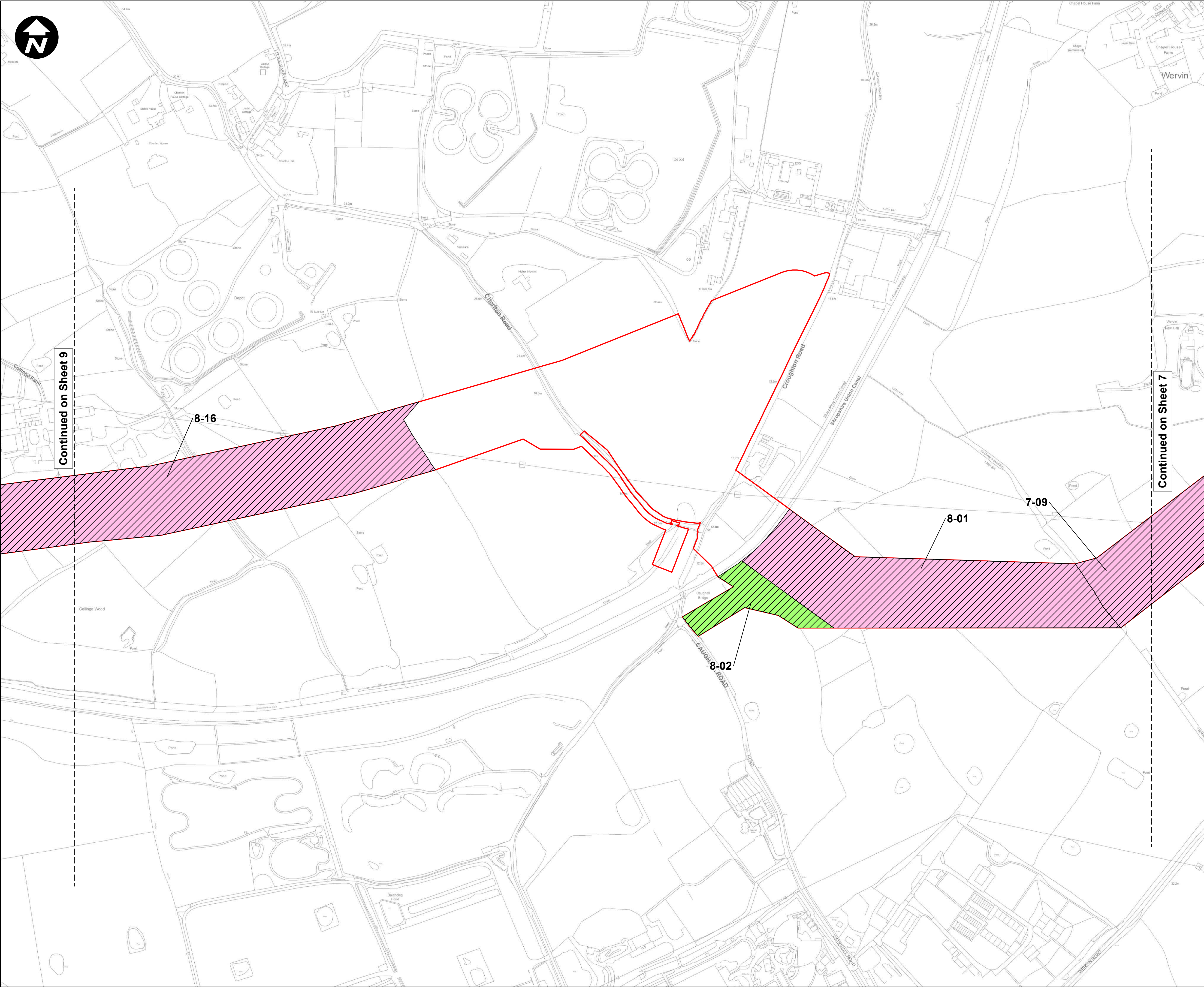

**Key:**

- Order Limits
- Permanent acquisition of subsurface
- Temporary possession of land
- Crown Land

1. All dimensions are in metres unless stated otherwise.
2. These Land Plans should be read in conjunction with other plans and documents in the Development Consent Order application in particular the Book of Reference.
3. All easements, servitudes and private rights in land are proposed to be extinguished on land shown coloured pink on these land plans. All easements, servitudes and private rights in land are proposed to be extinguished, so far as their continued exercise would be inconsistent with the exercise of the rights or restrictions proposed to be acquired by the undertaker on land shown coloured blue on these land plans. All easements, servitudes and private rights are proposed to be suspended while the undertaker is in temporary possession of the land shown coloured green on these land plans.
4. The number labels relate to plot numbers. Please refer to the Book of Reference for more information about these plots, including the approximate area of each plot (in square metres). Plot numbers include a reference to the relevant sheet of the Land Plans. In this numbering convention, a plot number comprises the sheet number followed by the actual plot number, e.g. Plot 01-24, where '01' is the sheet number (sheet 1) and '24' is the plot number (24 on sheet 1).

B	NC	RB	VB	28/02/2023
A	PM	JH	VB	27/09/2022
REVISION	DRAWN	CHECKED	APPROVED	DATE

**SCALE: 1:2,500**

0 50 100 200 Metres

Mapping reproduced by permission of Ordnance Survey on behalf of HMSO

Contains OS data © Crown Copyright and database right 2022

PROJECT TITLE

**HyNet Carbon Dioxide Pipeline DCO**

DRAWING TITLE

CROWN LAND PLANS REGULATION (5)(2)(n)  
APPLICATION DOCUMENT REFERENCE D.2.3  
SHEET 8 of 37

DRAWING STATUS

**ERRATA / S51 SUBMISSION**

DRAWN	CHECKED	APPROVED	AUTHORISED
NC	RB	VB	AV

SCALE @ A1 SIZE	DATE	REVISION
1:2,500	13/01/2023	B

DRAWING NUMBER

EN070007-D.2.3-CLP-Sheet 8



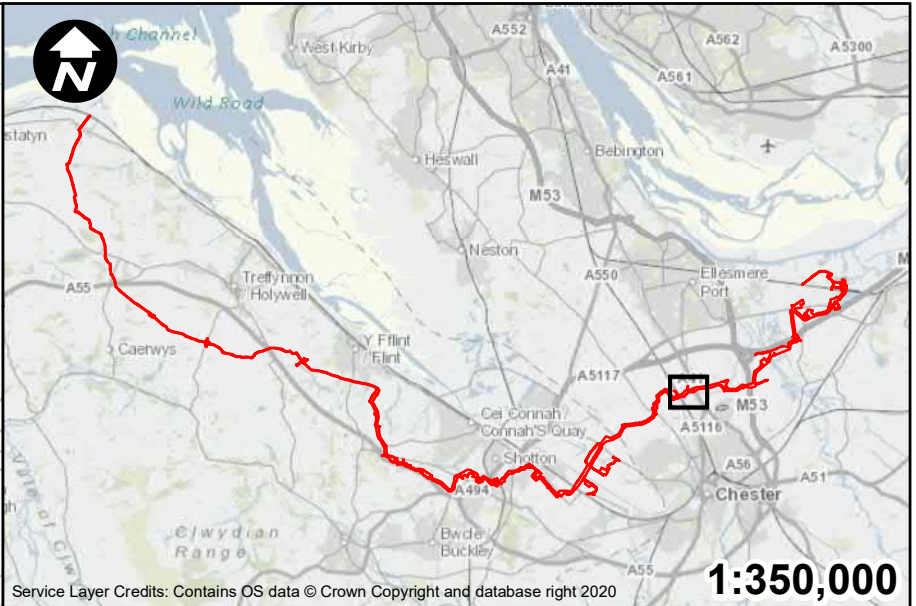
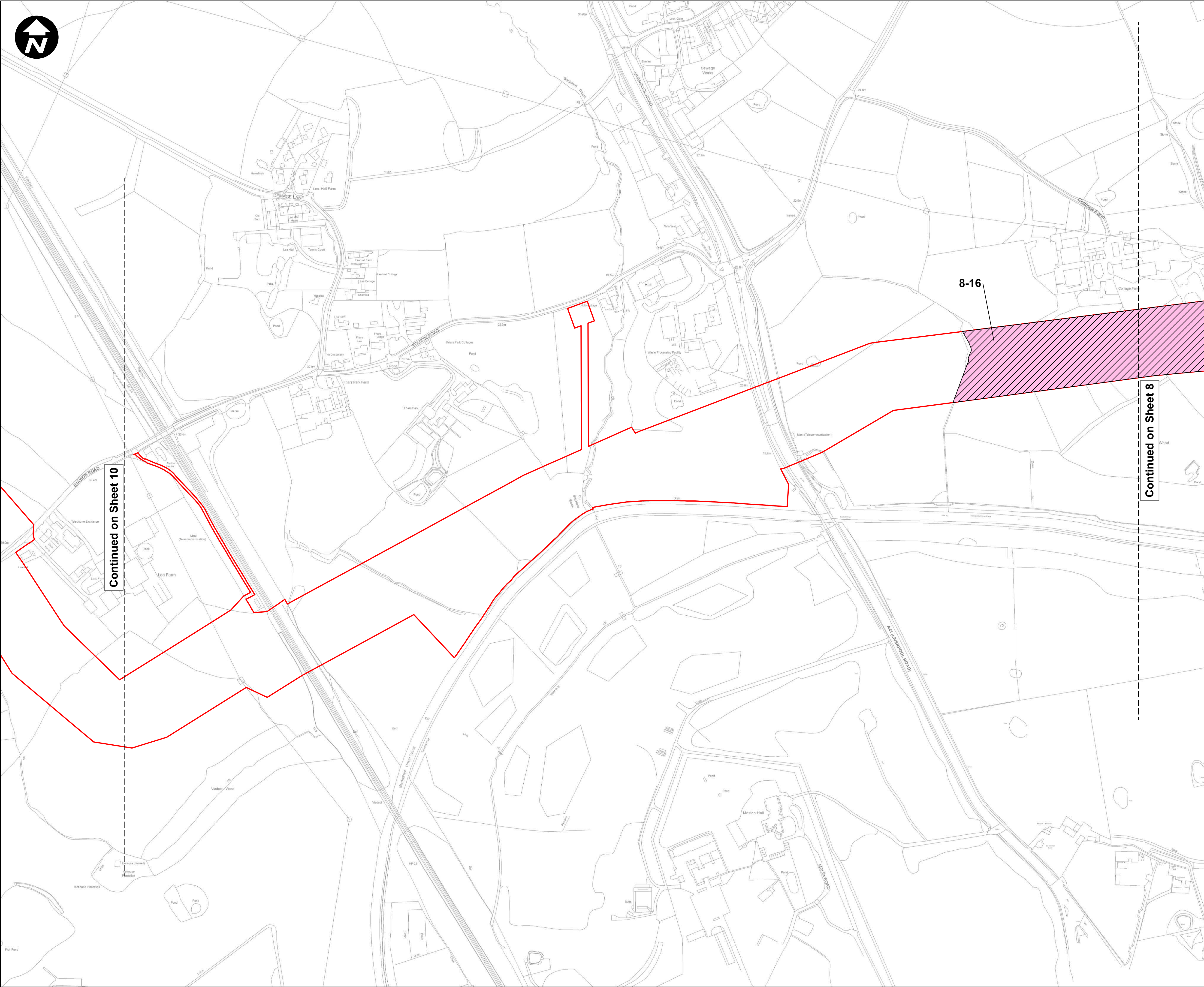

**Key:**

- Order Limits
- Permanent acquisition of subsurface
- Crown Land

1. All dimensions are in metres unless stated otherwise.
2. These Land Plans should be read in conjunction with other plans and documents in the Development Consent Order application in particular the Book of Reference.
3. All easements, servitudes and private rights in land are proposed to be extinguished on land shown coloured pink on these land plans. All easements, servitudes and private rights in land are proposed to be extinguished, so far as their continued exercise would be inconsistent with the exercise of the rights or restrictions proposed to be acquired by the undertaker on land shown coloured blue on these land plans. All easements, servitudes and private rights are proposed to be suspended while the undertaker is in temporary possession of the land shown coloured green on these land plans.
4. The number labels relate to plot numbers. Please refer to the Book of Reference for more information about these plots, including the approximate area of each plot (in square metres). Plot numbers include a reference to the relevant sheet of the Land Plans. In this numbering convention, a plot number comprises the sheet number followed by the actual plot number, e.g. Plot 01-24, where '01' is the sheet number (sheet 1) and '24' is the plot number (24 on sheet 1).

B	NC	RB	VB	28/02/2023
A	PM	JH	VB	27/09/2022

REVISION	DRAWN	CHECKED	APPROVED	DATE
----------	-------	---------	----------	------

**SCALE: 1:2,500**

0 50 100 200 Metres

Mapping reproduced by permission of Ordnance Survey on behalf of HMSO

Contains OS data © Crown Copyright and database right 2022

PROJECT TITLE

**HyNet Carbon Dioxide Pipeline DCO**

DRAWING TITLE

CROWN LAND PLANS REGULATION (5)(2)(n)  
APPLICATION DOCUMENT REFERENCE D.2.3  
SHEET 9 of 37

DRAWING STATUS

**ERRATA / S51 SUBMISSION**

DRAWN	CHECKED	APPROVED	AUTHORISED
NC	RB	VB	AV

SCALE @ A1 SIZE	DATE	REVISION
1:2,500	13/01/2023	B

DRAWING NUMBER

EN070007-D.2.3-CLP-Sheet 9



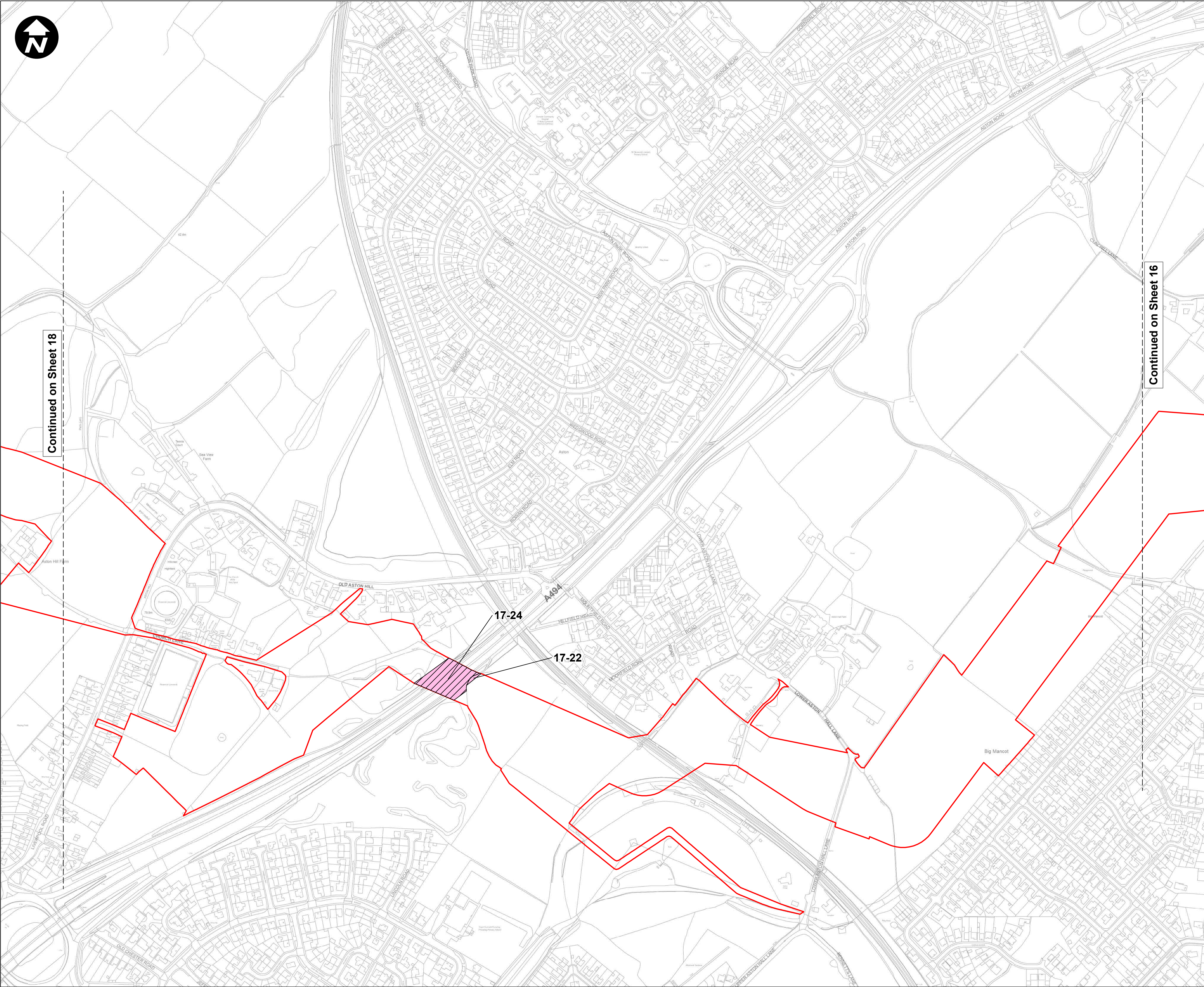

**Key:**

- Order Limits
- Permanent acquisition of subsurface
- Crown Land

1. All dimensions are in metres unless stated otherwise.
2. These Land Plans should be read in conjunction with other plans and documents in the Development Consent Order application in particular the Book of Reference.
3. All easements, servitudes and private rights in land are proposed to be extinguished on land shown coloured pink on these land plans. All easements, servitudes and private rights in land are proposed to be extinguished, so far as their continued exercise would be inconsistent with the exercise of the rights or restrictions proposed to be acquired by the undertaker on land shown coloured blue on these land plans. All easements, servitudes and private rights are proposed to be suspended while the undertaker is in temporary possession of the land shown coloured green on these land plans.
4. The number labels relate to plot numbers. Please refer to the Book of Reference for more information about these plots, including the approximate area of each plot (in square metres). Plot numbers include a reference to the relevant sheet of the Land Plans. In this numbering convention, a plot number comprises the sheet number followed by the actual plot number, e.g. Plot 01-24, where '01' is the sheet number (sheet 1) and '24' is the plot number (24 on sheet 1).

B	NC	RB	VB	28/02/2023
A	PM	JH	VB	27/09/2022
REVISION	DRAWN	CHECKED	APPROVED	DATE



Mapping reproduced by permission of Ordnance Survey on behalf of HMSO

Contains OS data © Crown Copyright and database right 2022

## HyNet North West

PROJECT TITLE

### HyNet Carbon Dioxide Pipeline DCO

DRAWING TITLE

CROWN LAND PLANS REGULATION (5)(2)(n)  
APPLICATION DOCUMENT REFERENCE D.2.3  
SHEET 17 of 37

DRAWING STATUS

ERRATA / S51 SUBMISSION

DRAWN	CHECKED	APPROVED	AUTHORISED
NC	RB	VB	AV
SCALE @ A1 SIZE		DATE	REVISION
1:2,500		13/01/2023	B

DRAWING NUMBER

EN070007-D.2.3-CLP-Sheet 17



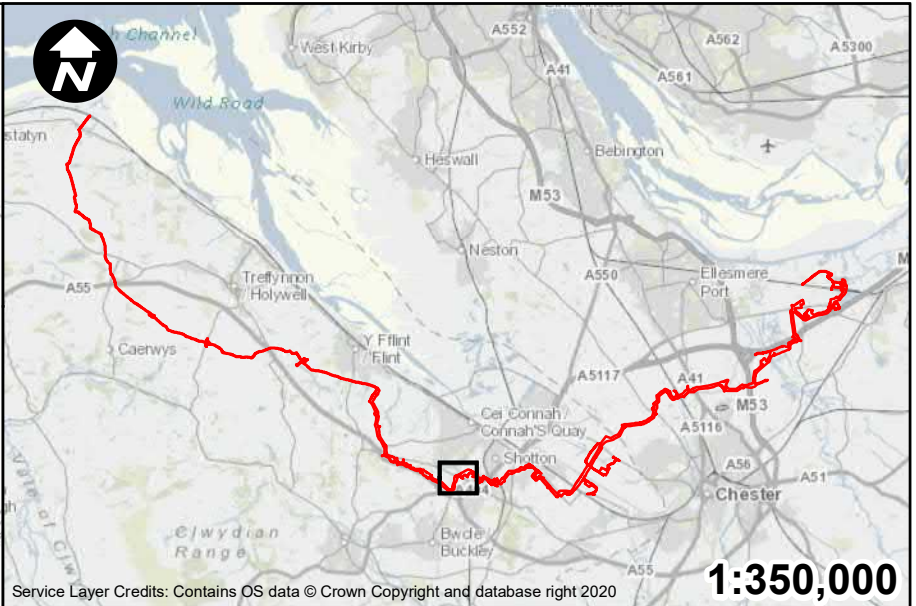
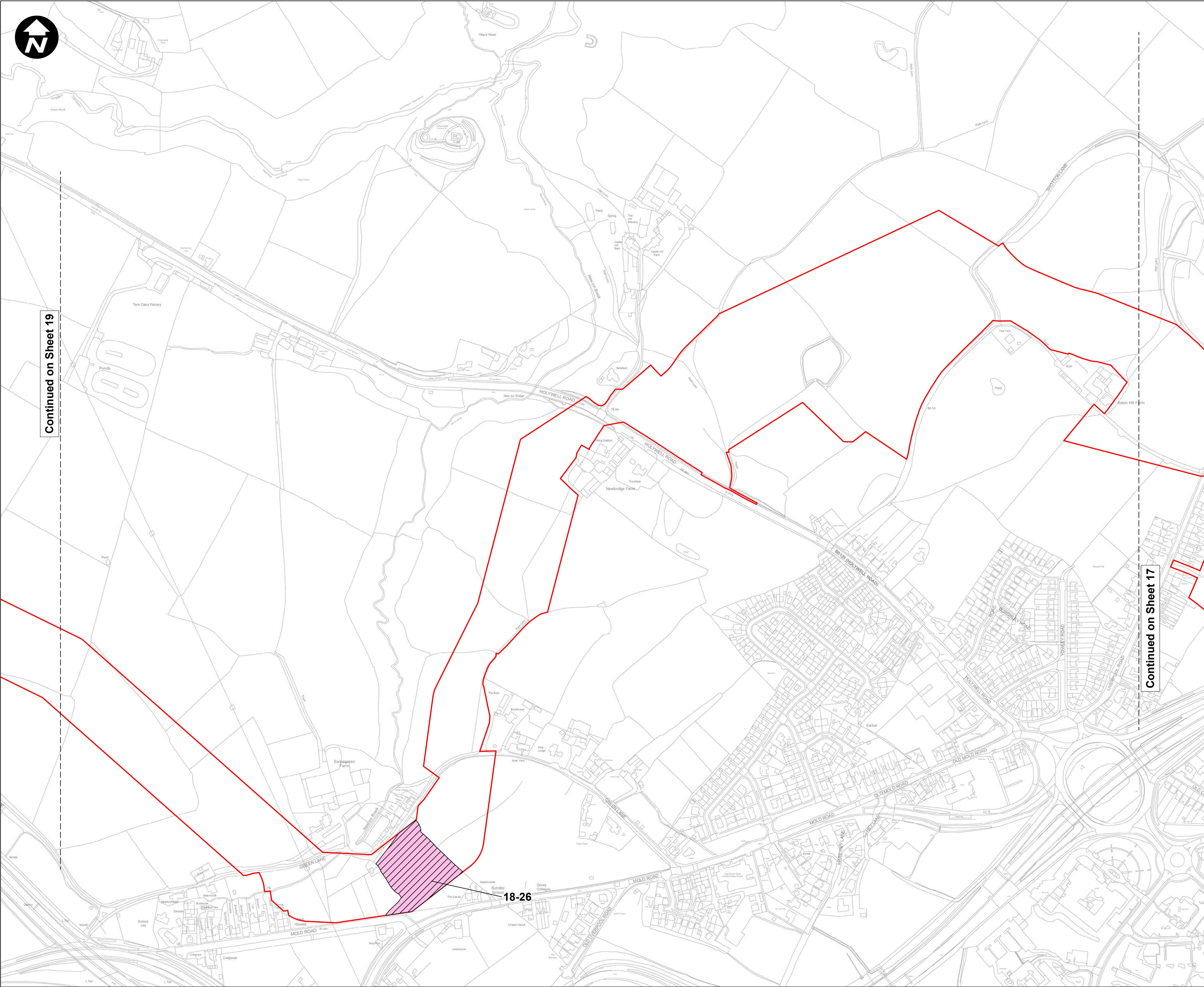

**Key:**

- Order Limits
- Permanent acquisition of subsurface
- Crown Land

1. All dimensions are in metres unless stated otherwise.
2. These Land Plans should be read in conjunction with other plans and documents in the Development Consent Order application in particular the Book of Reference.
3. All easements, servitudes and private rights in land are proposed to be extinguished on land shown coloured pink on these land plans. All easements, servitudes and private rights in land are proposed to be extinguished, so far as their continued exercise would be inconsistent with the exercise of the rights or restrictions proposed to be acquired by the undertaker on land shown coloured blue on these land plans. All easements, servitudes and private rights are proposed to be suspended while the undertaker is in temporary possession of the land shown coloured green on these land plans.
4. The number labels relate to plot numbers. Please refer to the Book of Reference for more information about these plots, including the approximate area of each plot (in square metres). Plot numbers include a reference to the relevant sheet of the Land Plans. In this numbering convention, a plot number comprises the sheet number followed by the actual plot number, e.g. Plot 01-24, where '01' is the sheet number (sheet 1) and '24' is the plot number (24 on sheet 1).

B	NC	RB	VB	28/02/2023
A	PM	JH	VB	27/09/2022
REVISION	DRAWN	CHECKED	APPROVED	DATE



Mapping reproduced by permission of Ordnance Survey on behalf of HMSO

Contains OS data © Crown Copyright and database right 2022

## HyNet North West

PROJECT TITLE

### HyNet Carbon Dioxide Pipeline DCO

DRAWING TITLE

CROWN LAND PLANS REGULATION (5)(2)(n)  
APPLICATION DOCUMENT REFERENCE D.2.3  
SHEET 18 of 37

DRAWING STATUS

#### ERRATA / S51 SUBMISSION

DRAWN	CHECKED	APPROVED	AUTHORISED
NC	RB	VB	AV
SCALE @ A1 SIZE		DATE	REVISION
1:2,500		13/01/2023	B

DRAWING NUMBER

EN070007-D.2.3-CLP-Sheet 18



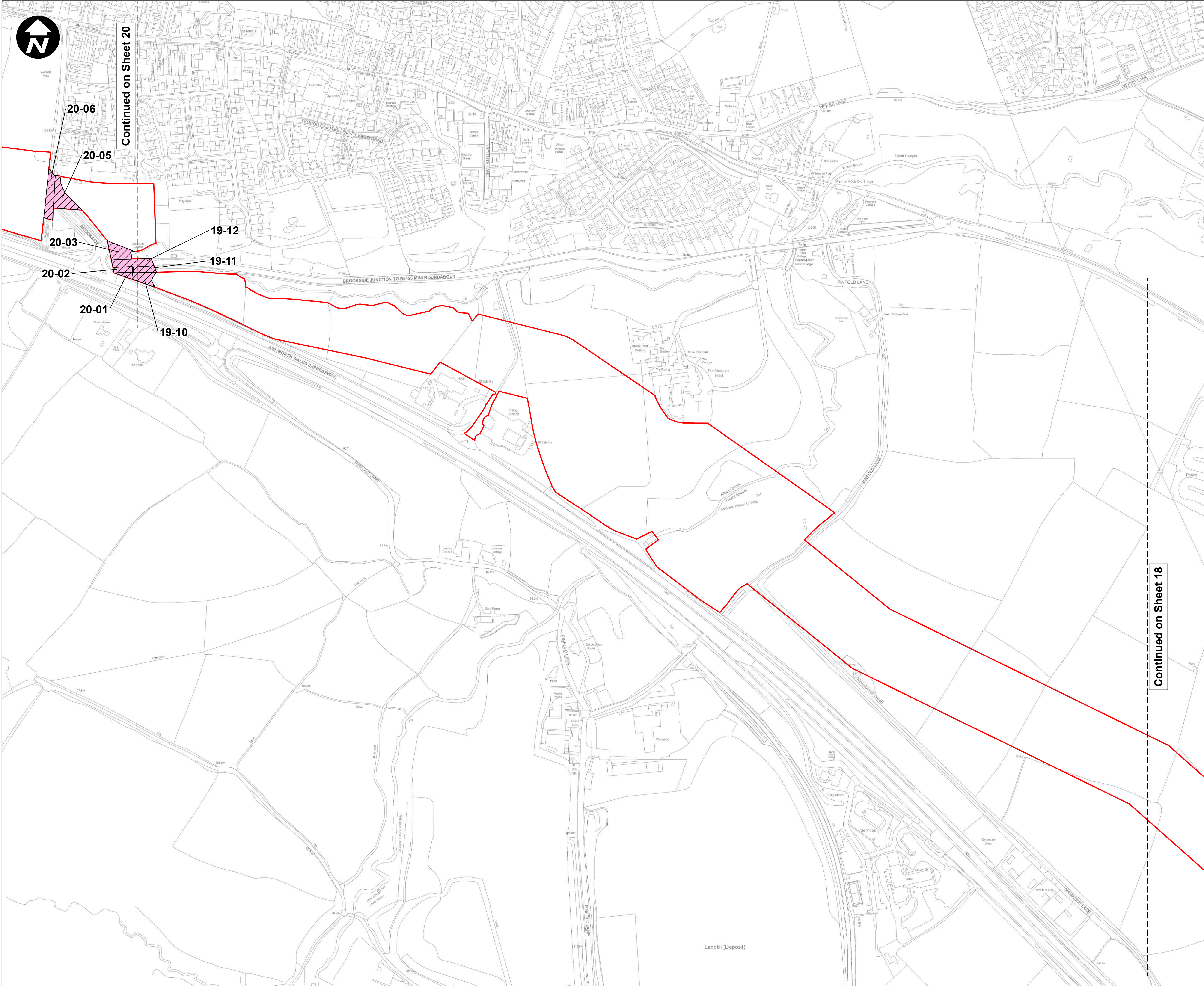

- Key:**
- Order Limits
  - Permanent acquisition of subsurface
  - Crown Land

- All dimensions are in metres unless stated otherwise.
- These Land Plans should be read in conjunction with other plans and documents in the Development Consent Order application in particular the Book of Reference.
- All easements, servitudes and private rights in land are proposed to be extinguished on land shown coloured pink on these land plans. All easements, servitudes and private rights in land are proposed to be extinguished, so far as their continued exercise would be inconsistent with the exercise of the rights or restrictions proposed to be acquired by the undertaker on land shown coloured blue on these land plans. All easements, servitudes and private rights are proposed to be suspended while the undertaker is in temporary possession of the land shown coloured green on these land plans.
- The number labels relate to plot numbers. Please refer to the Book of Reference for more information about these plots, including the approximate area of each plot (in square metres). Plot numbers include a reference to the relevant sheet of the Land Plans. In this numbering convention, a plot number comprises the sheet number followed by the actual plot number, e.g. Plot 01-24, where '01' is the sheet number (sheet 1) and '24' is the plot number (24 on sheet 1).

B	NC	RB	VB	28/02/2023
A	PM	JH	VB	27/09/2022
REVISION	DRAWN	CHECKED	APPROVED	DATE

SCALE: 1:2,500

0 50 100 200 Metres

Mapping reproduced by permission of Ordnance Survey on behalf of HMSO

Contains OS data © Crown Copyright and database right 2022

**HyNet North West**

PROJECT TITLE

**HyNet Carbon Dioxide Pipeline DCO**

DRAWING TITLE

CROWN LAND PLANS REGULATION (5)(2)(n)  
APPLICATION DOCUMENT REFERENCE D.2.3  
SHEET 19 of 37

DRAWING STATUS

ERRATA / S51 SUBMISSION

DRAWN	CHECKED	APPROVED	AUTHORISED
NC	RB	VB	AV
SCALE @ A1 SIZE	DATE	REVISION	
1:2,500	13/01/2023	B	

DRAWING NUMBER

EN070007-D.2.3-CLP-Sheet 19



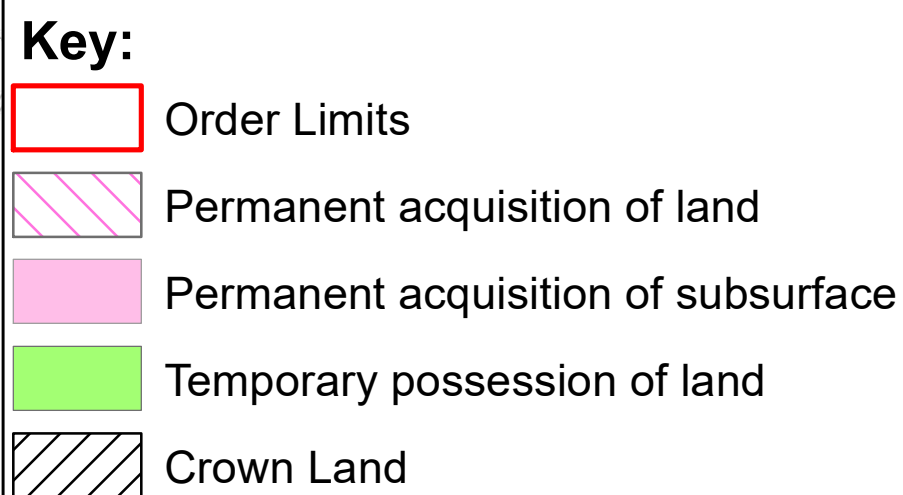
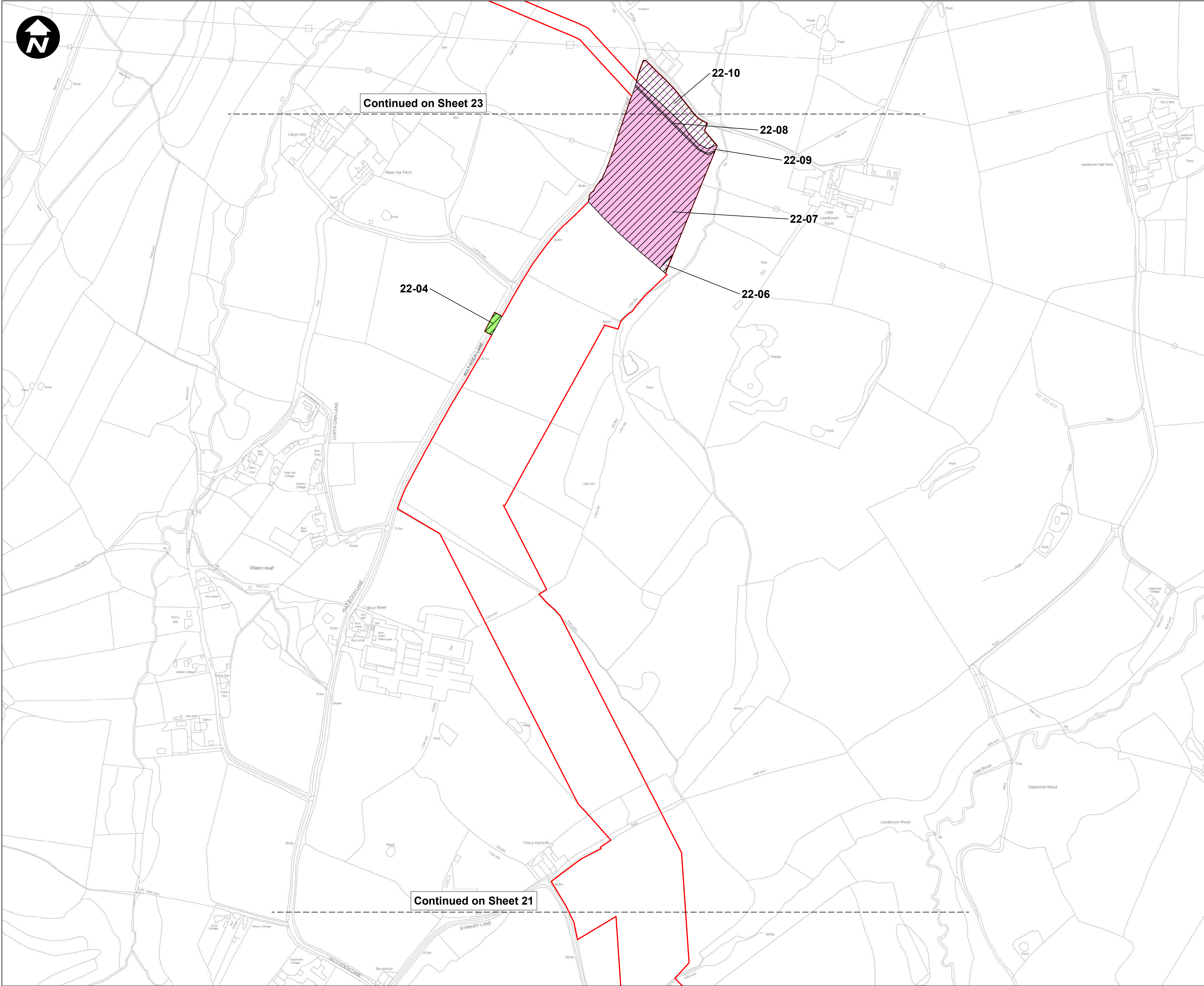

1. All dimensions are in metres unless stated otherwise.
2. These Land Plans should be read in conjunction with other plans and documents in the Development Consent Order application in particular the Book of Reference.
3. All easements, servitudes and private rights in land are proposed to be extinguished on land shown coloured pink on these land plans. All easements, servitudes and private rights in land are proposed to be extinguished, so far as their continued exercise would be inconsistent with the exercise of the rights or restrictions proposed to be acquired by the undertaker on land shown coloured blue on these land plans. All easements, servitudes and private rights are proposed to be suspended while the undertaker is in temporary possession of the land shown coloured green on these land plans.
4. The number labels relate to plot numbers. Please refer to the Book of Reference for more information about these plots, including the approximate area of each plot (in square metres). Plot numbers include a reference to the relevant sheet of the Land Plans. In this numbering convention, a plot number comprises the sheet number followed by the actual plot number, e.g: Plot 01-24, where '01' is the sheet number (sheet 1) and '24' is the plot number (24 on sheet 1).

B	NC	RB	VB	28/02/2023
A	PM	JH	VB	27/09/2022
<b>REVISION</b>	<b>DRAWN</b>	<b>CHECKED</b>	<b>APPROVED</b>	<b>DATE</b>

SCALE: 1:2,500

0 50 100 200 Metres



Mapping reproduced by permission of Ordnance Survey on behalf of HMSO

Contains OS data © Crown Copyright and database right 2022

# HyNet North West

PROJECT TITLE

**HyNet Carbon Dioxide  
Pipeline DCO**

**DRAWING TITLE**

CROWN LAND PLANS REGULATION (5)(2)(n)  
APPLICATION DOCUMENT REFERENCE D.2.3  
SHEET 22 of 37

DRAWING STATUS	ERRATA / S51 SUBMISSION
----------------	-------------------------

DRAWN NC	CHECKED RB	APPROVED VB	AUTHORISED AV
-------------	---------------	----------------	------------------

SCALE @ A1 SIZE 1:2,500	DATE 13/01/2023	REVISION B
----------------------------	--------------------	---------------

DRAWING NUMBER

EN070007-D.2.3-CLP-Sheet 22